

GEMINI HYBRID KIT USER MANUAL

SAFETY WARNING & INSTRUCTIONS

Please read this user manual carefully before using the product and keep the product in a safe place.

1.Warning for vulnerable consumer groups: The sale and use of e-cigarettes is prohibited for people under the age of 21. The use of e-cigarettes and liquids during pregnancy and breastfeeding, or by a non-smoker is not recommended. Keep this e-cigarette and its components out of the reach from children.

2.Battery Caution: Do not expose the device to extreme temperatures. Do not disassemble the device to service or change the battery without Lost Vape's recommendation. This is a high end and powerful device capable of providing a high voltage to the atomizer. We recommend only using the single 18650 battery (Not Included) in a proper manner. Only dispose of Lithium Polymer batteries at suitable waste disposal facilities.

3. Atomizer Caution: Don't over-tighten the atomizer onto the 510 connector; the atomizer should be snugged, not tightened. Over-tightening may cause damage to the threading and the Delrin insulator.

4. Verify The Authenticity: Please verify that the product is an authentic Lost Vape product before purchasing it. Fake and shoddy products may damage your personal health. To verify the product, please refer to <https://lostvape.com/anti-counterfeit/> and follow the steps described in the New Verification System. If you have any questions, please contact us by email, phone or our website to get help.

5. Contacts: For further questions or inquiries, please contact Lost Vape by email at support@lostvape.com or visit our website: www.lostvape.com.

6.Warranty: The device is covered by a 3-month warranty from the date of purchase. Please check our Warranty Guidelines for further information. Coils and/or accidental damages are not covered by this warranty.

1 MAIN FEATURE

- 80W MAX OUTPUT POWER
- 18650 SINGLE BATTERY (Not Included)
- ADJUSTABLE AIRFLOW
- EASY SIDE REFILL
- 510 ADAPTOR FOR TANK

2 STANDARD PACKAGE

- 1× Gemini Hybrid Kit
- 1× Micro USB Cable
- 1× 1.0Ω UB MTL Coil
- 1× 510 MTL Drip Tip
- 1× Set of O-Ring
- 1× User Manual
- 1× Pod (4ML Pre-installed)
- 1× 0.2Ω UB M4 Coil (Pre-installed)
- 1× AFC Ring
- 1× 510 Adaptor
- 1× Warranty Card

3 BASIC PARAMETERS

Dimension	81.4mm×48mm×23mm
Weight	155g
Battery	Single 18650 Battery (Not Included)
Battery Voltage	3.0V-4.2V
Output Voltage	0.8V-4.0V
Power Range	5-80W
Current Range	0.3A-22A
Screen	0.96" Color TFT Display
Coil Resistance Supported Range	0.12Ω-5.0Ω
Body Material	Zinc Alloy

4 COMPONENTS OVERVIEW

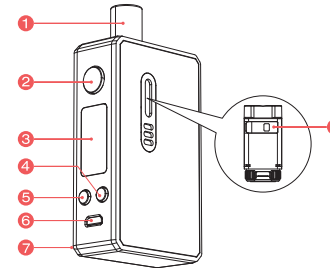

① 510 Drip Tip	⑤ Left Button (-)
② Fire Button	⑥ USB Port
③ Full-Color TFT Display Screen	⑦ Magnetic Cover
④ Right Button (+)	⑧ E-liquid Refilling Plug

5 BASIC OPERATION

● TURN ON/TURN OFF

Press the Fire button 5 times consistently within 2 seconds to TURN ON/ TURN OFF the device. Without any operations, screen will be dark in 10s, and it will turn into sleep mode in another 10s.

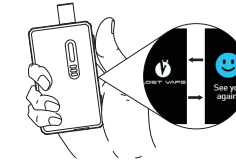

● SET UP

Using the Left (-) and Right (+) buttons to adjust the wattage under POWER mode to the desired value.



Instagram: @lost_vape

Facebook: @lost_vape

Website: www.lostvape.com

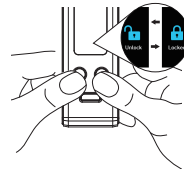

● WATTAGE LOCK/UNLOCK

Press and hold the Left (-) and Right (+) button at the same time to Lock and Unlock the wattage setting.

● PUFF TIME and PUFF COUNT RESET

Press and hold the Fire and Right (+) button at the same time to reset the puff time and puff count.

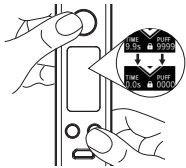

● SCREEN COLOR CHANGE

Press and hold the Fire and Left (-) button at the same time to change the color theme.

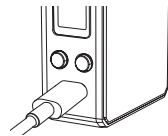
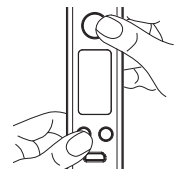

● CHARGING

The device has a built-in DC 5V USB port. Connect the micro USB cable to a power source, the battery icon will begin to animate and stop animating once fully charged (Battery Voltage ≥ 4.18V).

Attention: Check for the positive and negative poles of batteries before charging. Battery icon will still animate even battery reversal, but no current exist.

● HOW TO FILL WITH E-LIQUID

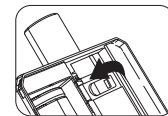
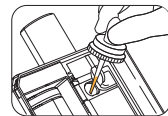
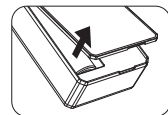

① Take out the magnetic cover;

② Unplug the e-liquid refilling plug;

③ Refill pod from e-liquid filling slot;

④ Seal the pod after filling.

● HOW TO TAKE OUT THE POD

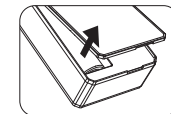

① Take out the magnetic cover;

② Take out the drip tip;



③ Pull out the pod by pressing down the top-side slot of it.

● HOW TO REPLACE COIL

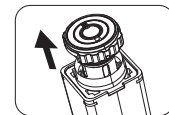

① Take out the pod;

② Take out the coil;

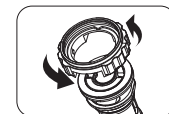

③ Unscrew the AFC ring;



④ Screw the new coil back to the AFC Ring;

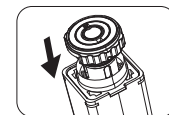

⑤ Push the coil back into the pod;



⑥ Put the pod back to the device;

● HOW TO CHANGE THE 510 ADAPTOR

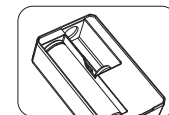

① Take out the magnetic cover, drip tip and pod;



② Press the 510 adaptor back to the device with the cut-side of the 510 connector facing outward.

Attention:

1. Make sure the pod upside down before pull out the coil when there is juice still left in the pod to avoid leakage of the e-liquid.
2. The pod can only put back in with the e-liquid filling plug facing outward as its structural design of drip tip connector.

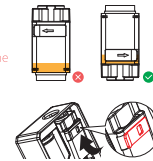

6 DESCRIPTION OF WARNING



No pass-through: Vaping is not allowed when the device is charging. The screen will show "No pass-through" if it is power on.



Low Battery: The "Low Battery" message means battery voltage below 3.2V before use or lower than 3.0V when you are using, this will continue to display for a few seconds after attempting to fire the device. Users should remove and replace the battery.



Check Atomizer: You will be asked to "Check Atomizer" when no atomizer detected, or the atomizer resistance is higher than 3Ω.

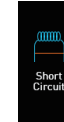

Short Circuit: When the atomizer resistance is lower than 0.1Ω, the screen displays "Short circuit" once you press the Fire button.



Too Hot: The device will shut down and display "TOO HOT" once the temperature of internal board is higher than 80°C. You can use the device again when the temperature is back to 60°C.



Over 10s: Output will automatically cut off and screen shows "Over 10s" when you fire over 10s continuously.